



Educational Project Showcase

Caterlink is Western Australia's largest, most experienced and respected commercial kitchen supplier and contractor. All our staff are passionate about the hospitality industry and over the years we are proud to have been involved in some of the largest kitchen projects in the state — spanning training centres; restaurants; hotels; hospitals and healthcare facilities; mining, oil and gas sites; supermarkets and major public facilities.

WE HAVE OUTFITTED:

Scotch College
Perth College
Wesley College
St John's College - Darwin
Penrhos College

Santa Maria College
Shenton College
Mirrabooka Senior High School
Woodvale Senior High School

Central Midland (Moora) Senior High School
Northam Senior High School
West Coast College of TAFE
The University of Western Australia

OTHER PROJECTS INCLUDE:

Crown Casino developments (Rockpool, Nobu, Modo Mio, Bistro – Guillaume, The Atrium, The Merrywell, Poolside Bar & Grill), Fusion, Champagne Bar and Junction Grill
The Trustee Bar & Bistro
IKEA Restaurant

Fiona Stanley Hospital
Jimblebar Accommodation Village
Hope Downs Accommodation Village
... and much more!

*Thanks for your time, patience and expertise with our students last week. It was great to hear the stories and see our Year 10's motivated and engaged. Caterlink provided the best solution for our Trade Training Centre needs from the outset and they have been hands-on every step of the way since. The after sales service provided by both yourself and Brian has been exceptional. You guys always seem more than happy to go the extra mile and share your expertise with our staff and students. I know that if we need anything in the future we just have to ask and you will be there. Thanks for your support. **Kerriann Henderson – Teacher/ Trade Training Centre Coordinator, Belmont City College.***



08 9492 8200



CaterlinkWA



**26 Howe Street
Osborne Park WA 6017**



@CaterlinkWA

www.caterlink.com.au



PERTH COLLEGE



WESLEY COLLEGE

Capability Statement

Caterlink has the expertise, experience and support to provide superior commercial kitchen solutions to a diverse range of sectors, in most geographic regions, during construction or production stages of a project.

Strength and Stability: Caterlink is a wholly owned West Australian Company, part of the Chrystal Group of Companies. The Chrystal Group is a diversified portfolio of business and property interests which includes overseas manufacturing operations and international distribution of branded products.

Experience: Founded in 1977, Caterlink has grown to be the leading provider of commercial kitchens in Western Australia, having completed many of the state's largest and most complex kitchen projects. This includes the Crown Casino Perth, the Perth Convention and Exhibition Centre, Subiaco Oval and numerous remote mining camps.

Capability: Caterlink's strength is derived from a highly motivated and experienced team with skills across the full spectrum of commercial kitchen requirements. This includes kitchen design, equipment specification and sourcing, full service drawing capability, project coordination, installation, commissioning and training. Caterlink are widely acknowledged by suppliers and customers as the most professional, progressive and innovative provider of commercial kitchen solutions in Australia. Caterlink has also completed a number of overseas projects requiring cultural awareness and specification of relevant kitchen design and equipment to suit varying cultural needs.

Upgrades: Our team has the experience and capability to install new kitchens or upgrade existing ones. Our upgrade service provides a detailed analysis of existing premises, equipment and services, to derive a solution that meets the client's new requirements, whilst meeting all regulatory and health standards.

People: Businesses are comprised of people, and Caterlink are proud to have leading professionals in all key areas.

Our Services

- Full kitchen design service including: bars, refrigeration and dish-wash facilities
- Equipment selection, suggestions and recommendations
- CAD drawings with backup equipment schedule
- Supply of all commercial catering equipment including such brands as Waldorf, Electrolux, Goldstein, Convotherm, Rational, Hobart, Washtech, Simply Stainless and custom stainless steel bench work, exhaust hoods etc

Design and Concept Drawings

Caterlink offers design and project management expertise with a focus on your vision. Our beginning-to-end project capability enables us to provide quality project management — combining big-picture thinking with absolute attention to detail.

We work hard to ensure our clients receive quality, performance and value in choosing our products and services, no matter the size or complexity of the project. Here are some examples of our attention to detail:

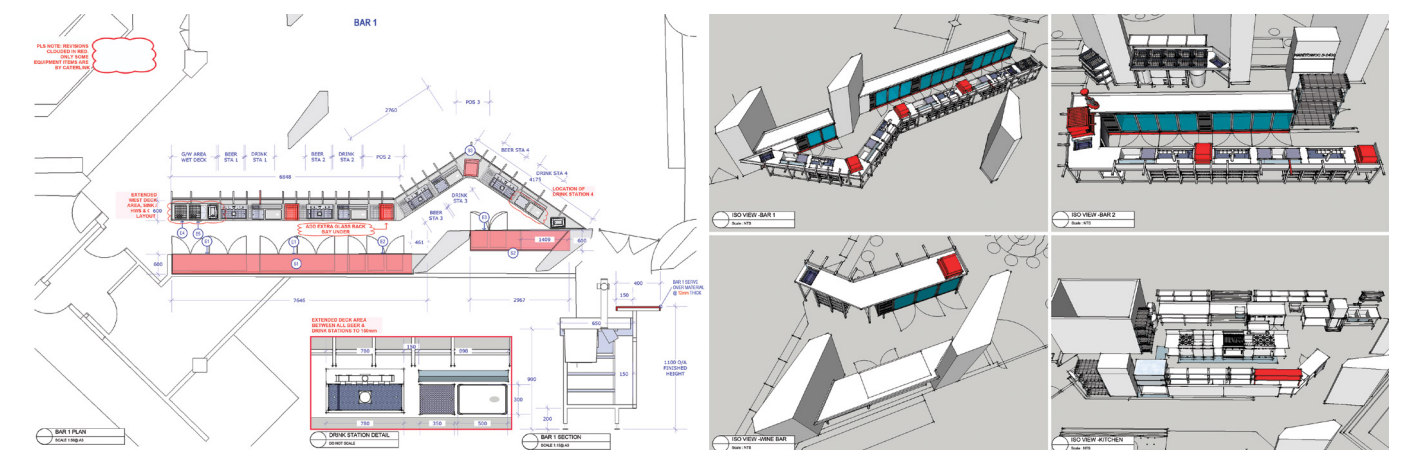



Benefits to You

- Plans designed prior to lease signing allow you to better negotiate tenancy improvements.
- We design functional, efficient work areas that require fewer employees, therefore lowering labour costs.
- Our designs facilitate faster customer service, thereby increasing sales and profits.
- With the floor plan, services required and equipment specified by one vendor; the result is fewer mistakes and build-out costs.
- We can expedite the overall project design by providing the correct equipment, CAD blocks and services required to the project architect. This support will continue during the project installation, as we work with your general contractor.

For more information please contact:



Alphonso Devellerez

Education Specialist

26 Howe Street

Osborne Park WA 6017

P: 9492 8200

M: 0438 932 459

E: alphonso@caterlink.com.au

[in au.linkedin.com/pub/alphonso-devellerez/89/72b/93](https://au.linkedin.com/pub/alphonso-devellerez/89/72b/93)



Adrian Tobin

Business Development Manager

26 Howe Street

Osborne Park WA 6017

P: 9492 8200

M: 0407 449 599

E: atobin@caterlink.com.au

[in au.linkedin.com/in/adriantobincaterlink](https://au.linkedin.com/in/adriantobincaterlink)



Caterlink

the best commercial kitchen solutions

08 9492 8200

26 Howe Street
Osborne Park WA 6017

www.caterlink.com.au